

# DGG-1.0

## Digital Grip Gauge

### INSTRUCTION SHEET PAGE 1 OF 2

The Digital Thickness Gauge has a measuring range of 0-1" (0-25,4mm). The minimum hole size the instrument is capable of measuring through is of 7/64" (2,77mm).

Ports for Digital Output to an SPC or other data collection system are included; just connect to your data collection device with appropriate cables.

**Caution: This is a precision instrument. Handle with care.**

#### DIMENSIONAL DATA (all dimensions are in inches)

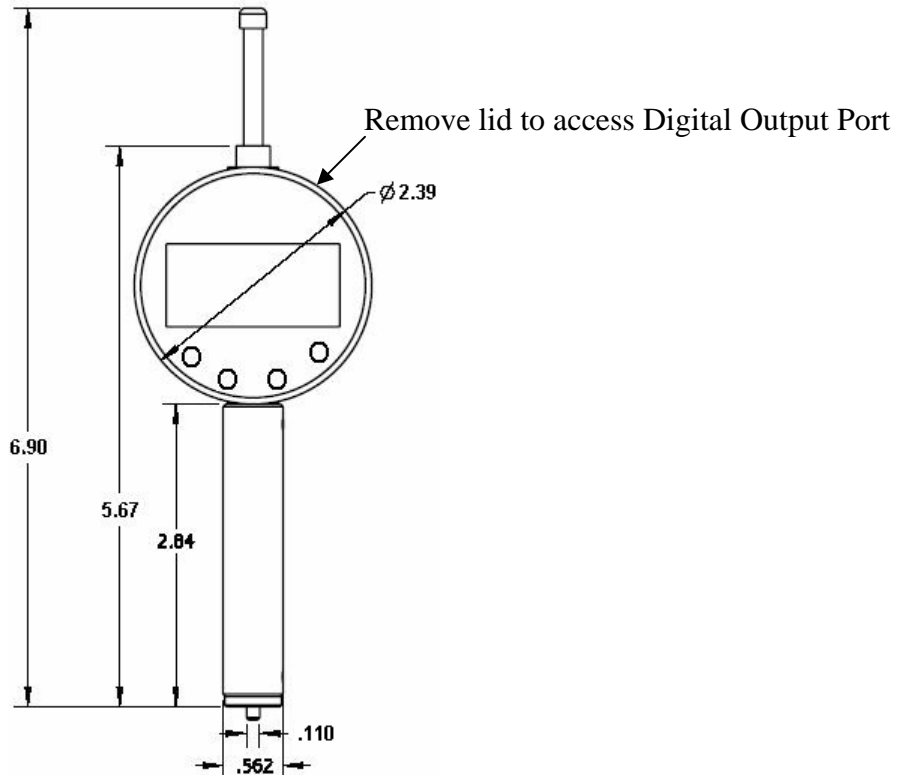

#### OPERATING INSTRUCTIONS

##### Before use, make sure that:

- The active areas and measuring datum of the Gauge are clean and in good condition
  - The plunger can be easily pressed and fully returns upon release

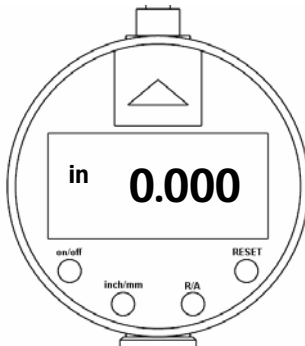

##### Zero Gauge setup:

- Depress the "ON/OFF" button to turn the power on
- Make sure the Gauge is set to the appropriate units of measurement (inch/mm)
  - Depress the "inch/mm" button to shift between units
- Depress the R/A button if "REL" is displayed
- Depress "RESET" to zero out the gauge prior to measurement: ".000<sup>in</sup>" will be displayed when the gauge is ready for measurement



**CHERRY**®  
AEROSPACE

1224 East Warner Ave,  
Santa Ana, CA 92705  
Tel: 1-714-545-5511  
www.cherryaerospace.com

# DGG-1.0

## Digital Grip Gauge

### INSTRUCTION SHEET PAGE 2 OF 2

#### Thickness Measurements:

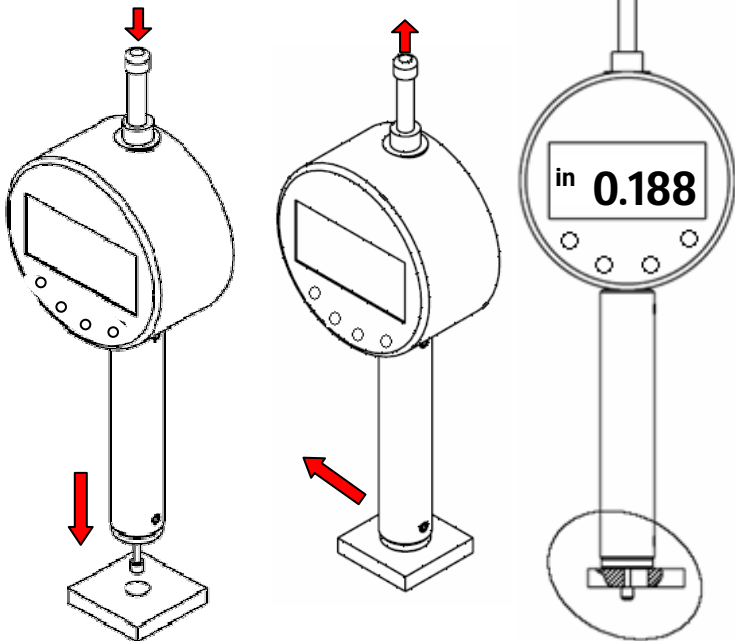

#### MEASURING PROCEDURE

##### Zero-in & select units per instructions above.

- Insert plunger through the hole
- Press plunger to extend beyond the thickness of the material to measure
- Bring sideways to the edge of the hole to insure that the plunger reads the bottom surface of the hole.
- Release plunger and press R/A button
- Press the plunger and carefully pull out of the hole
- Allow plunger to slowly return to the ready position
- Read the recorded measurement on the display and depress the R/A button
- Repeat the procedure for the next reading

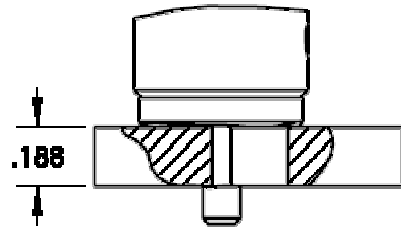

#### MAINTENANCE INSTRUCTIONS

Remove lid to access the battery

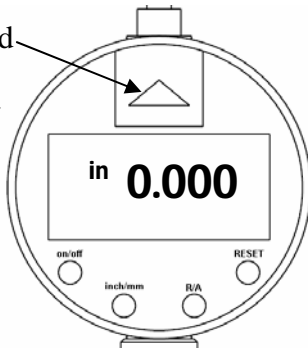

- Make sure that the gauge is handled carefully and kept clean
- When random numbers are displayed on the screen and the gauge cannot be zeroed-in, the battery is low- change the battery
- Remove battery if the gage is not being used for long periods of time.
- Use: Silver Oxide battery AG13 / LR44 for replacement

#### WARRANTY

Seller warrants the goods conform to applicable specifications and drawings and will be manufactured and inspected according to generally accepted practices of companies manufacturing industrial or aerospace fasteners. In the event of any breach of the foregoing warranty, Buyer's sole remedy shall be to return defective goods (after receiving authorization from Seller) for replacement or refund of the purchase price, at the Seller's option. Seller agrees to any freight costs in connection with the return of any defective goods, but any costs relating to removal of the defective or nonconforming goods or installation of replacement goods shall be Buyer's responsibility. SELLER'S WARRANTY DOES NOT APPLY WHEN ANY PHYSICAL OR CHEMICAL CHANGE IN THE FORM OF THE PRODUCT IS MADE BY BUYER. THE FOREGOING EXPRESS WARRANTY AND REMEDY ARE EXCLUSIVE AND ARE IN LIEU OF ALL OTHER WARRANTIES AND REMEDIES; ANY IMPLIED WARRANTY AS TO QUALITY, FITNESS FOR PURPOSE, OR MERCHANTABILITY IS HEREBY SPECIFICALLY DISCLAIMED AND EXCLUDED BY SELLER. This warranty is void if seller is not notified in writing of any rejection of the goods within ninety (90) days after receipt of the goods by buyer.

Seller shall not be liable under any circumstances for incidental, special or consequential damages arising in whole or in part from any breach by Seller, AND SUCH INCIDENTAL, SPECIAL, OR CONSEQUENTIAL DAMAGES ARE HEREBY EXPRESSLY EXCLUDED.

Our policy is one of continuous development. Specifications shown in this document may be subject to changes introduced after publication.

NOTE: The properties, strength, dimensions, installed characteristics and all other information in these materials are for guidance only to aid in the correct selection of the products described herein and is not intended or implied as part of the above warranty. All applications should be evaluated for functional stability and available samples of the described parts can be requested for installed tests, suitability and evaluations.

For more information please contact our Technical Services Department at tel. 714-850-6022



**CHERRY**<sup>®</sup>  
AEROSPACE

1224 East Warner Ave,  
Santa Ana, CA 92705  
Tel: 1-714-545-5511  
www.cherryaerospace.com